

AIRDoctor®

USER MANUAL

AD1000 / AIR PURIFIER



AIRDoctor®

AIRDOCTORPRO.COM

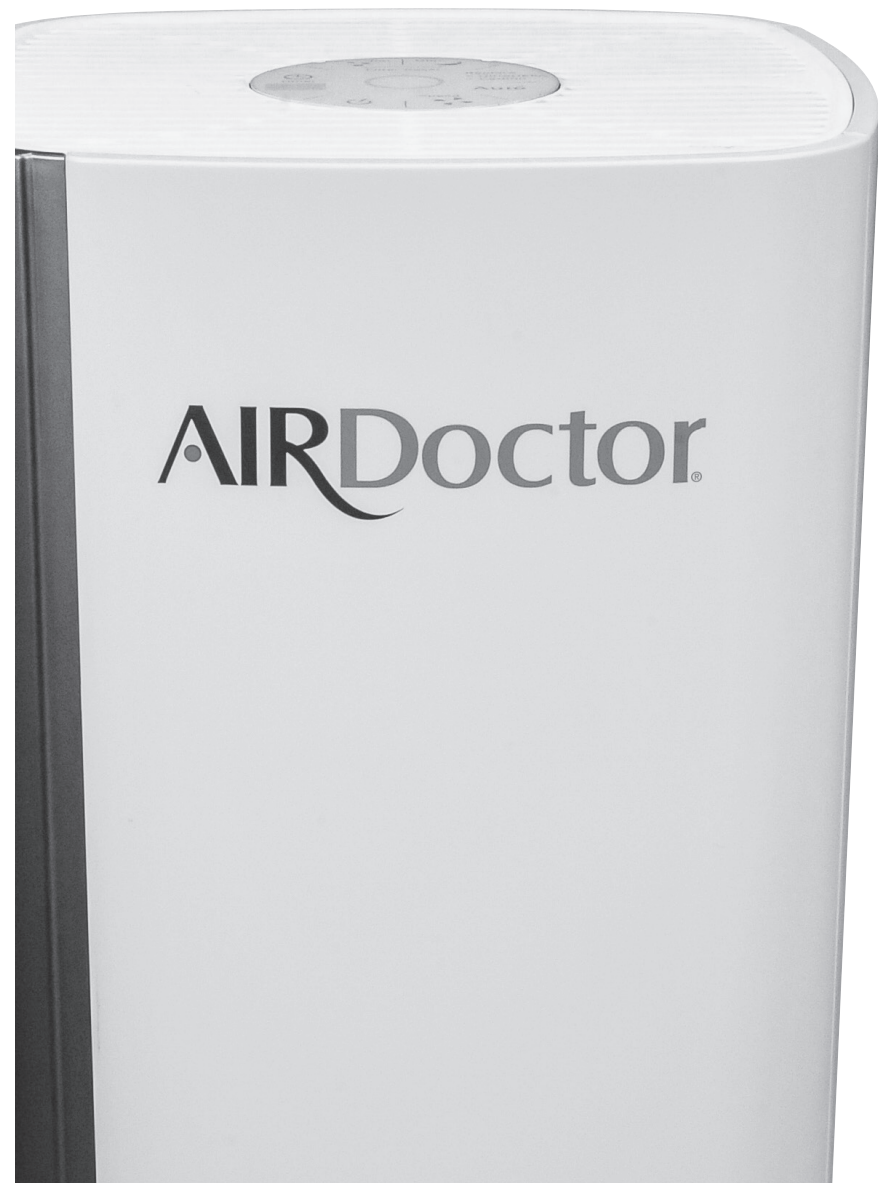



THANK YOU

Congratulations on purchasing the AirDoctor AD1000 professional air purifier and your commitment to controlling the quality of your indoor air.

With the AirDoctor AD1000 professional air purifier, we provide UltraHEPA™ filtration to purify the air and remove allergens. In addition, AirDoctor AD1000 is equipped with an activated carbon filter to remove odor and VOCs. Get ready to experience cleaner air!

PLEASE NOTE: It is crucial that you read and follow all the instructions and safety warnings in this manual for optimal performance of your air purifier and your health and safety.

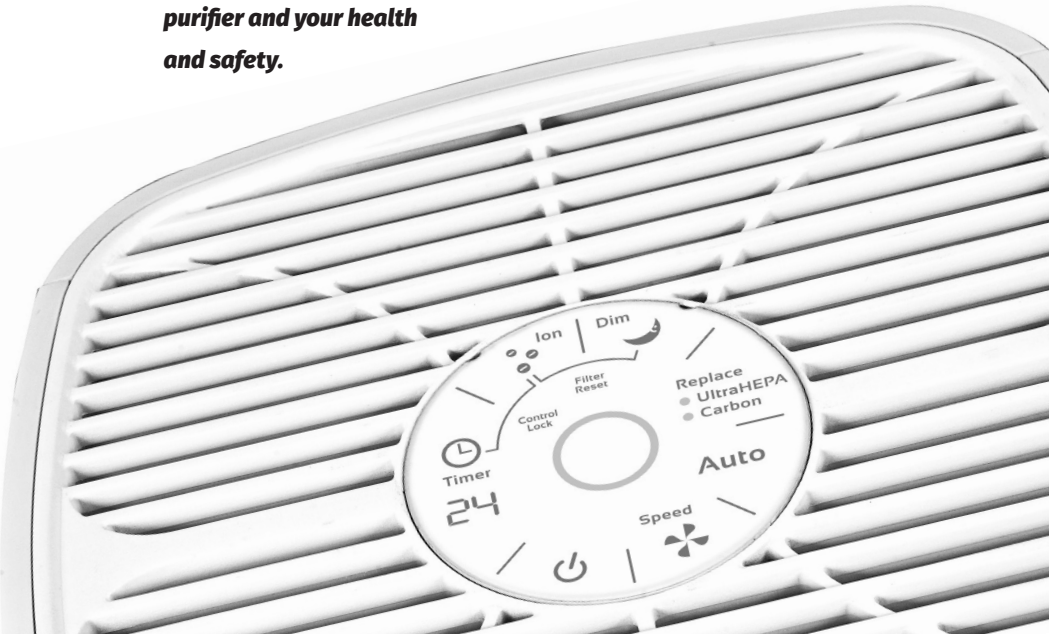

TABLE OF CONTENTS

SAFETY INSTRUCTIONS	2
PRODUCT BENEFITS	3
KNOWING YOUR AIRDOCTOR AIR PURIFIER	4
Main Parts	4
PROPER USAGE	5
OPERATING YOUR AIRDOCTOR AIR PURIFIER	6
Control Panel	6
Air Quality Monitor	6
Control Lock	7
MAINTENANCE	8
Maintaining the AirDoctor Air Purifier	9
TROUBLE-SHOOTING	10
CUSTOMER SERVICE CONTACT INFORMATION	11
ONE-YEAR LIMITED WARRANTY	11
ARBITRATION AGREEMENT	12

SAFETY INSTRUCTIONS

WARNING: RISK OF ELECTRIC SHOCK

READ AND SAVE THESE INSTRUCTIONS.

Safety precautions should always be used when operating this or any electrical appliance. Decrease the risk of electrocution, electric shock, injury or fire by reading and following all the warnings below.

Use this product only as described in this AirDoctor professional air purifier owner's guide. To reduce the risk of electric shock, do not attempt to service the product in any way other than in the manner described in the "Maintenance" section of this guide.

- ⦿ Read all instructions before operating the AirDoctor professional air purifier.
- ⦿ This product operates at 120V AC, 60Hz only.
- ⦿ Do not run the power cord under carpets or cover with throw rugs.
- ⦿ Do not operate the product in a greasy environment such as in the kitchen. This product is not intended to filter oil or grease from air.
- ⦿ Do not use the AirDoctor professional air purifier in bathrooms, near sinks or other wet & humid environments, near fireplaces or in areas where flammable or combustible vapors or products may exist.
- ⦿ Always unplug the power cord from the electrical outlet when the purifier is not in use, before cleaning, inserting or removing parts or before moving to another location.
- ⦿ Never run the air purifier unless it is fully assembled.
- ⦿ To reduce the risk of electric shock, this product has a polarized plug (one blade is wider than the other). This plug will fit into a polarized outlet only one way. If the plug does not fit into the outlet, contact qualified service personnel to install the proper outlet. Do not alter the plug in any way.
- ⦿ Always turn off all controls before unplugging the AirDoctor professional air purifier from outlet.
- ⦿ Attempting to service the AirDoctor professional air purifier in any way not described in this owner's guide will void the warranty and could cause serious personal injury to the user and/or result in considerable damage to the unit.
- ⦿ Do not place the cord near a heated surface.
- ⦿ Never operate the AirDoctor professional air purifier if the plug or cord is damaged or appears damaged. Only qualified service personnel should replace a damaged power cord.
- ⦿ Never use the power cord to pick up, carry, drag, pull or lift the AirDoctor professional air purifier. Do not pull the cord against or around sharp corners and edges. This could result in injury to the user or damage to the cord.
- ⦿ Always remove the plug from its power outlet by holding onto the plug itself and pulling gently. Never pull on the cord itself to unplug it from its power outlet.
- ⦿ Use care when operating the AirDoctor professional air purifier by keeping all foreign objects, fingers and other body parts, hair, loose clothing and jewelry away from openings.
- ⦿ Never touch the AirDoctor professional air purifier or its plug when your hands are wet.
- ⦿ The AirDoctor professional air purifier is an electrical appliance. Adult supervision is required when operating around children.

PRODUCT BENEFITS

THE REVOLUTIONARY AIRDOCTOR PROFESSIONAL AIR PURIFIER CLEANS AIR WITH ULTRAHEPA™ FILTRATION.

The AirDoctor professional air purifier boasts many great features:

- ⦿ UltraHEPA™ filter removes microscopic particles from the air.
- ⦿ High quality Carbon filter removes VOCs (Volatile Organic Compounds) and controls odors.
- ⦿ Effectively removes smoke, pollen, dust, animal dander, dust mites from the air.
- ⦿ Powerful and quiet fan has 4 speed settings so you can select the desired cleaning level.
- ⦿ Air Quality Monitor shows current air quality.
- ⦿ Auto mode automatically adjusts fan speed depending on air quality.
- ⦿ A 24-hour timer to set the time of operation, from 1 hour up to 24 hours.
- ⦿ Built-in ionizer revitalizes air.
- ⦿ Night mode dims the control panel light when you sleep.
- ⦿ Clean filter indicator light.
- ⦿ Low power consumption-energy efficient.

Electrical Ratings

- 120 volt / 60 Hz
- Power consumption / 40 watts
- UltraHEPA™ filter
- Carbon filter
- Model: AD1000

Replacement Filters

- UltraHEPA™ filter / ADF1001
- Carbon filter / ADF1002

To order replacement filters go to airdoctorpro.com or call 800.221.2515.

KNOWING THE AIRDOCTOR AD1000 AIR PURIFIER

MAIN PARTS

1. Rear Cover
2. Carbon/VOC Filter
3. UltraHEPA™ / Pre-filter
4. Air-Outlet
5. Touch Control Panel
6. Air Quality Sensor Cover
7. Air Quality Sensor
8. Air Quality Monitor: The LED ring display will change color depending on air quality.

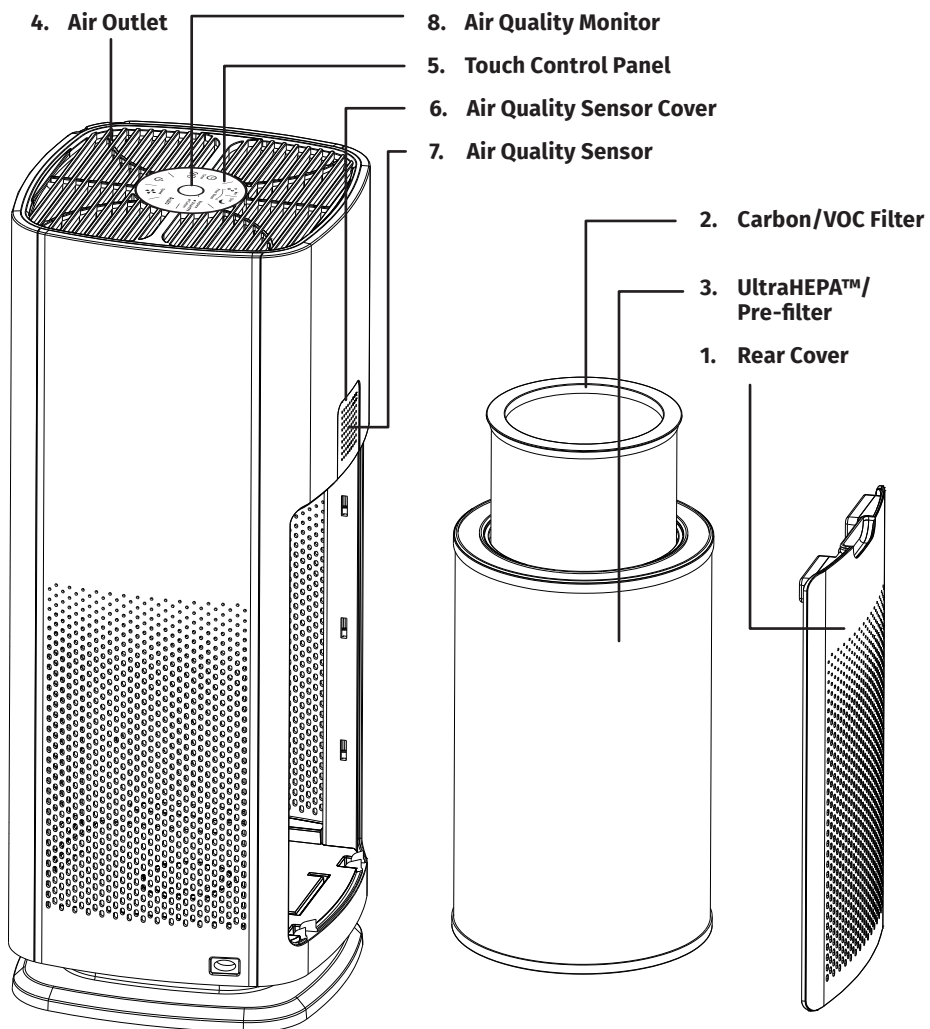

PROPER USAGE

Make sure the UltraHEPA™ & Carbon/VOC filters are properly installed before use.

1. Keep all sides of the unit more than 1 foot away from a wall.
2. Do not blow air from a fan or air conditioner directly into the air purifier.
3. Do not place the unit where the air inlet or outlet grill could come in contact with curtains or drapery.
4. Place the unit close to the source of air pollution to improve indoor air quality effectively.

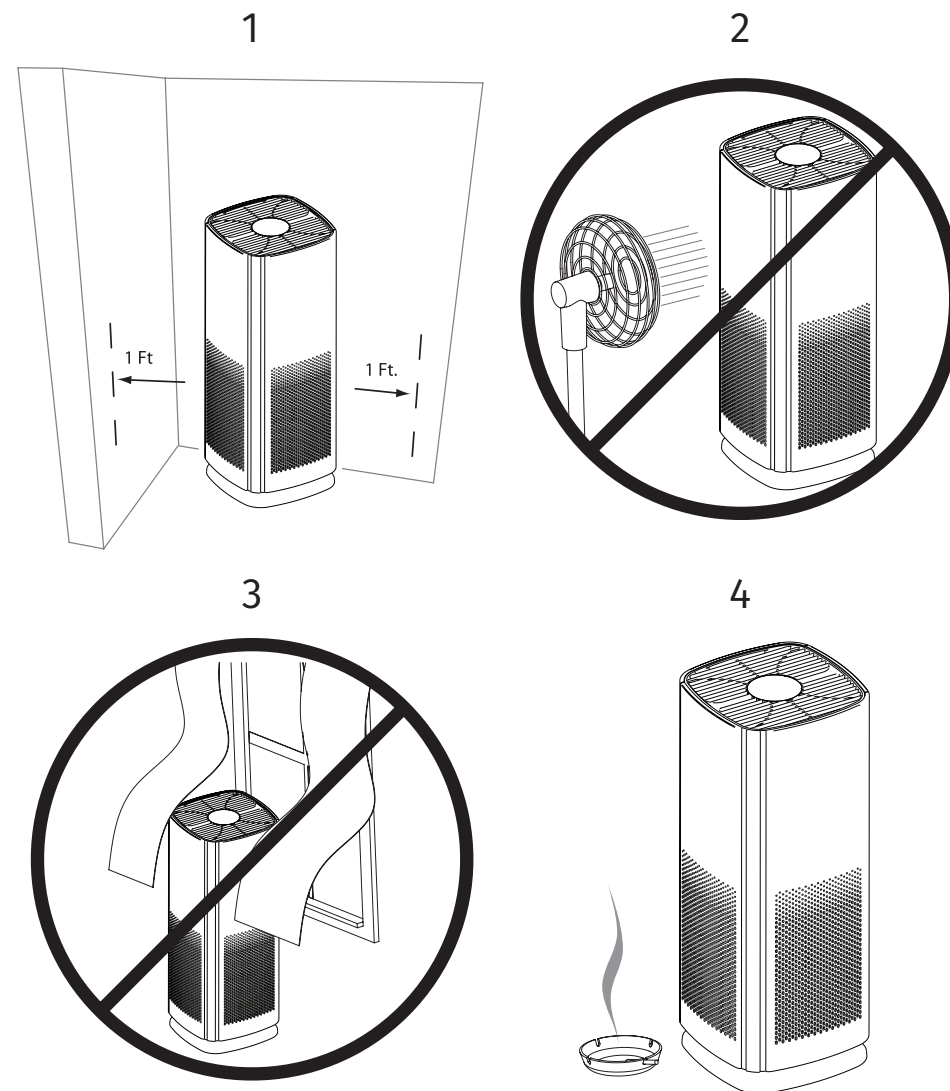

OPERATING THE AIRDOCTOR AD1000 AIR PURIFIER

Before first use, remove filters and remove plastic bag from filters, then reinstall filters. Then reinstall front cover.

Plug the unit into an electrical outlet. The unit will be ready to run. Read the following directions to select desired settings.

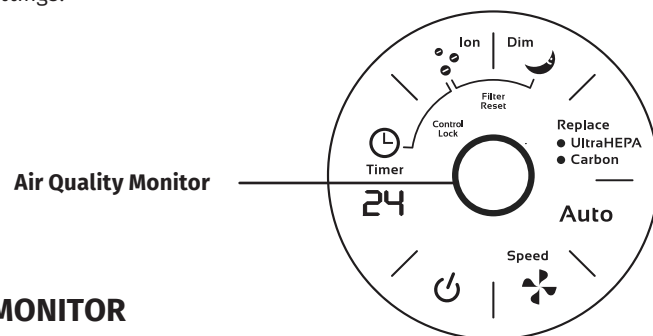

AIR QUALITY MONITOR

Air Monitor

The AirDoctor comes with an Air Quality Monitor that continuously monitors the quality of the air in the room. The LED light located on the front will light up according to the air quality. The Air Quality Monitor is able to show 3 air quality levels.

BLUE = Good air quality / **ORANGE** = Fair air quality / **RED** = Poor air quality

You can choose to set the AirDoctor to **"Auto"**. This will enable the AirDoctor to adjust the Fan speed according to the Air Quality. In **Auto** mode, the fan speed will be adjusted as follows:

Good Air Quality = Low fan speed

Fair Air Quality = Medium fan speed

Poor Air Quality = High and Boost fan speed

CONTROL PANEL

1. Power Control

As soon as you press the power button , the AirDoctor will start in the **Auto** mode. As soon as the auto program has been activated it will start up in the high-speed mode, the sensor will start to detect the amount of particulate in the air. As the particles are detected, the AirDoctor will select the purification speed (fan speed) that is appropriate to the particulate contamination in the room.

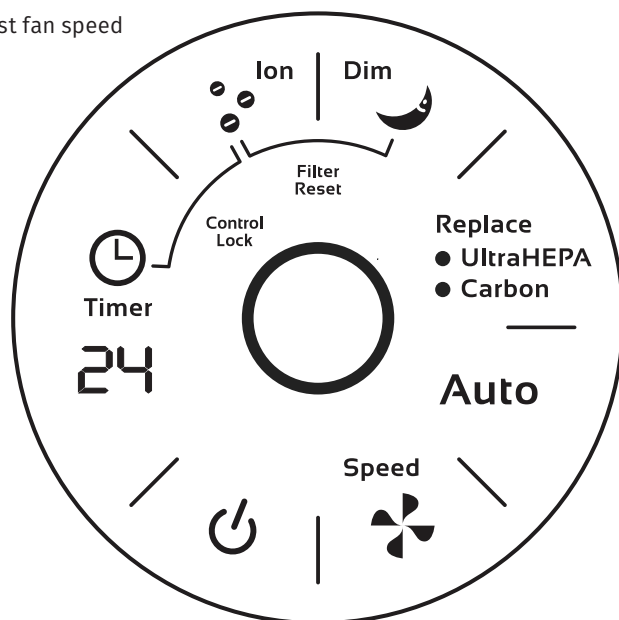

OPERATING THE AIRDOCTOR AD1000 AIR PURIFIER

In most cases we recommend that you leave the AirDoctor in the Auto mode, for other purification modes, see the next page.

2. Fan Speed Control

The AirDoctor has four different fan speed settings: Low, Medium, High, and Boost. Each mode has its own indicator light which lights up when the setting is chosen. The speed selected determines how rapidly you want to clean the air. The **"LOW"** and **"MEDIUM"** settings are great for everyday use. The **"HIGH"** setting is great for areas with more airborne contaminants (such as excessive smoke, pet dander, etc), or areas used frequently by allergy-sufferers. The **"BOOST"** setting is best used for shorter bursts of time when you want to rapidly purify the air.

3. Auto Mode

The AirDoctor is equipped with an air sensor to monitor the quality of your air. Simply press the **Auto** button to activate the air monitoring system. The monitor will test the air quality and automatically adjust the fan speed to remove the air contaminants. The top of the display is equipped with **LED lights** to notify you of the air quality. **RED** color is for poor, **ORANGE** for fair and **BLUE** for good quality air.

4. Dim Mode

If the LED lights are too bright, activate the **"Dim Mode"** to turn off the LED lights and the lighted display.

5. Timer Control

The AirDoctor air purifier can be programmed to turn off after a preset amount of time. Press the **"TIME"** button to program the timer. Each press will add one hour up to a total of 24 hours. Keeping the button pressed will automatically increase to 24 hours, 1 hour at a time.

6. ION Generator

Press the **ION** button to turn on the IONS. Press it again to turn the IONS off.

7. Clean Filter Indicator Light

The AirDoctor Clean Filter Indicator Light will turn on each time a filter needs to be replaced. To reset the filter indicator, **press the ION and DIM buttons together for 3 seconds**. The **CLEAN FILTER** light will flash 3 times and then turn off completely, indicating the unit has been reset.

8. 24-Hour Timer Display

CONTROL LOCK FEATURE

The AirDoctor has a Control Lock feature to prevent a person (child) or a pet from interrupting the running mode by accident. When the control lock feature has been activated, none of the buttons on the control panel will work. The only way to change any setting is to deactivate the control lockout feature or to unplug the AirDoctor.

To activate control lock feature

- Press **"Timer"** and **"Ion"** at the same time for **3 seconds**
- This may be done at anytime while the AirDoctor is running, including on Dim mode

To deactivate control lock feature

- **"Timer"** and **"Ion"** at the same time for **3 seconds**

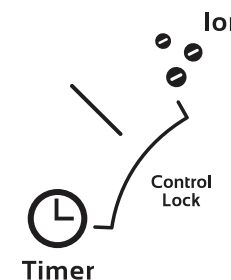

MAINTENANCE

The AirDoctor professional air purifier is almost maintenance free! The high quality Carbon/VOC and UltraHEPA™ filters last at least 6 months, depending on use and environment conditions.

Vacuum the outside of the UltraHEPA™ filter every 2 months.

Before replacing the UltraHEPA™ or Carbon/VOC filter of your AirDoctor professional air purifier, turn off and unplug the unit from the electrical outlet and read all safety instructions and important warnings in this owner's manual.

REPLACING THE ULTRAHEPA™ & CARBON/VOC FILTERS

1. Make sure the unit is turned off and unplugged. With the rear of the unit facing forward, pull the lid towards you at the upper end as shown and remove the rear cover.
2. Remove the UltraHEPA™ and Carbon/VOC filters by pulling the tabs straight out on the top and bottom of the filters.
3. The Carbon/VOC filter sits inside the HEPA filter. To remove the filter, simply pull up on the inner filter to separate it from the HEPA filter. Insert your new UltraHEPA™ and Carbon/VOC filters and slide them back into the rear of the unit, then insert the bottom of the inlet grill first and then snap the upper part of the rear cover back into position.
4. Make sure the bottom hooks are properly in place before snapping it up to its upright and locked position.

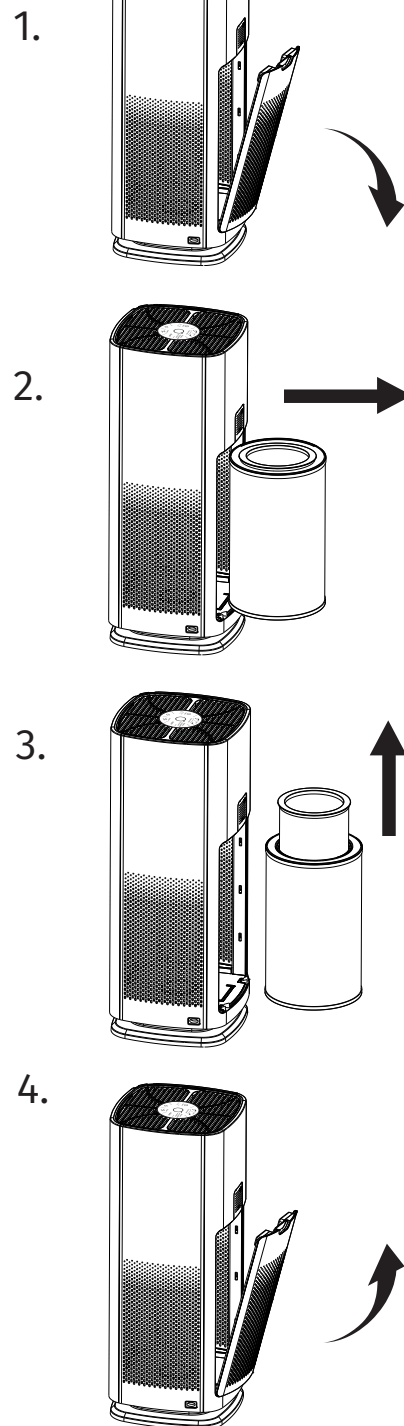
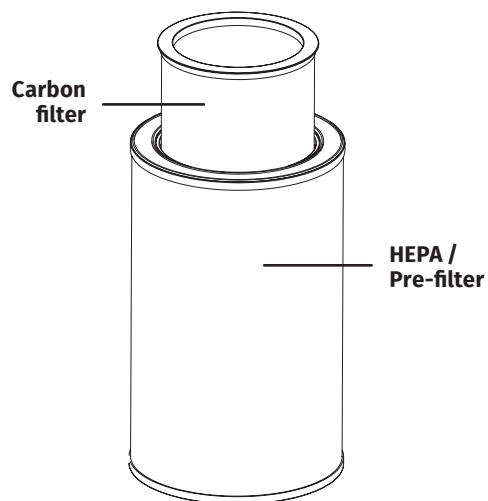

MAINTENANCE

Cleaning the Air Monitor

The AirDoctor is designed with an air monitor to track the quality of your air. Over time the monitor can become dirty and may require cleaning. The main symptom of a dirty air monitor is the LED display remains frozen on one light color. In order to clean the air monitor you must use a vacuum to clear the monitor chamber.

1. Power off and unplug unit.
2. Locate and open the air sensor panel door located on the rear of the unit. (Fig. 1)
3. Use a vacuum cleaner hose to suction any dust or dirt that may have accumulated inside the monitor chamber. (Fig. 2)

Figure 1

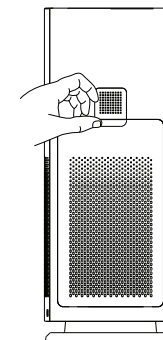
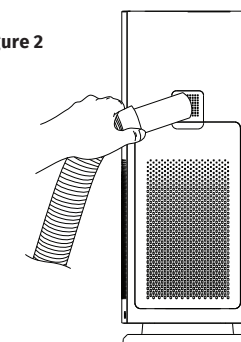

Figure 2



Cleaning the Pre-filter

Note the pre-filter is attached to the outside of the UltraHEPA™ filter and cannot be removed. See below for cleaning instructions.

1. Make sure the unit is turned off and unplugged. With the rear of the unit facing forward, pull the lid towards you at the upper end as shown and remove the rear cover.
2. Remove the UltraHEPA™ and Carbon/VOC filters by pulling the tabs straight out on the top and bottom of the filters.
3. Using the crevice tool, vacuum the outside of the UltraHEPA™ filter to remove large contaminants collected on the pre-filter.
4. Install the UltraHEPA™ filter back into the AirDoctor AD1000 housing.
5. Install the rear cover by first inserting the bottom hooks on the cover into the back housing before pushing the cover into the upright position on the AirDoctor housing.

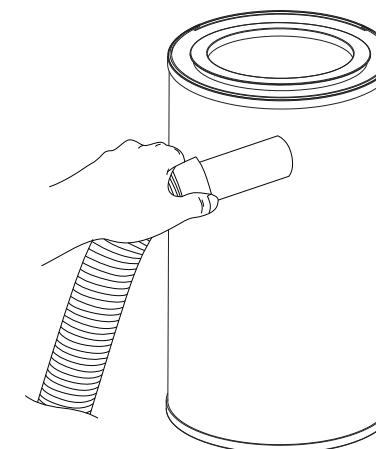

TROUBLESHOOTING

Before contacting our customer service department, please try the following solutions:

PROBLEM	REASON	SOLUTION
Unit won't operate.	ON/OFF button hasn't been pressed. Unit is unplugged.	Press ON/OFF button. Plug in unit.
Reduced air flow or poor filtering.	The inlet or outlet grill may be blocked. The UltraHEPA™ or Carbon/VOC filter may be clogged. Filters may still be in bags.	Ensure nothing is in front of or on top of the purifier. Check filters and replace it if necessary. (See instructions on pg. 8). Remove filters from bags.
The air quality monitor only illuminates blue.	The air in your room is clean.	The unit is operating normally, no action required.
The air quality monitor only illuminates yellow or red.	Either the air quality is very poor or the air monitor sensor has become dirty.	Clean the air sensor with a vacuum to restore the accuracy of the monitor. (See page 9 for instruction on how to clean the sensor).
The HEPA or CARBON filter light has come on and won't turn off.	The AirDoctor is designed to notify you when it is time to change each filter. These lights indicate that one of the filters needs to be replaced.	First, remove and replace the filter that needs to be changed. Second, press and hold the ION and DIM buttons simultaneously to reset the filter life tracker and turn off notification light.
The AUTO mode is not activating the ION mode.	The AUTO mode is designed to adjust the fan speed depending on the air quality. Other modes must be activated separately.	The unit is operating normally, no action required.

ONE-YEAR LIMITED WARRANTY

AIRDOCTOR ONE-YEAR LIMITED WARRANTY

Your AirDoctor air purifier is warranted to be free from defects in materials and workmanship for one year from the original purchase date. Should the product have a defect in materials or workmanship, we will repair or replace it without charge to you (a shipping and processing fee will apply). To obtain service under warranty, simply call our customer service center toll-free at **800.221.2515**.

This warranty does not cover damage caused by accident, misuse or any use other than as intended and described in this product manual, or damage resulting from failure to maintain and clean this product as specified in this product manual. This warranty applies only to the original purchaser of the AirDoctor air purifier. This warranty does not cover the filters.

AIRDOCTOR VOC AND HEPA LIMITED WARRANTY

Your AirDoctor particle filter (HEPA) and VOC (carbon) is warranted to be free from defects in material and workmanship for 30 days from the original purchase date. AirDoctor will replace a defective filter at no charge to you and cover any shipping charges. The limited warranty covers normal use only.

ALL EXPRESS AND IMPLIED WARRANTIES FOR THIS PRODUCT, INCLUDING IMPLIED WARRANTIES OF MERCHANTABILITY AND FITNESS FOR A PARTICULAR PURPOSE, ARE LIMITED IN DURATION TO THE WARRANTY PERIOD, AND NO WARRANTIES, WHETHER EXPRESS OR IMPLIED, WILL APPLY AFTER THIS PERIOD.

Some states do not allow limitations on the duration of implied warranties, so the above limitation may not apply to you. While this warranty gives you specific legal rights, you may also have other rights which may vary from state to state.

CONTACT INFO FOR WARRANTY SERVICE:

AirDoctor
P.O. Box 9159 | Van Nuys, CA | 91409-8291
800.221.2515 | airdoctorpro.com
©2020 AirDoctor, LLC. All Rights Reserved.

AIRDoctor®

ARBITRATION AGREEMENT

PLEASE READ THIS AGREEMENT CAREFULLY. YOU ACCEPT THE TERMS OF THIS AGREEMENT BY RETAINING THE PRODUCT(S) SHIPPED IN CONNECTION WITH THIS AGREEMENT (THE "PRODUCTS") FOR MORE THAN THIRTY (30) DAYS AFTER RECEIPT. IF YOU DO NOT AGREE TO THE TERMS OF THIS AGREEMENT, YOU MAY RETURN THE PRODUCT TO COMPANY WITHIN THIRTY (30) DAYS OF RECEIPT FOR A FULL REFUND.

THIS ARBITRATION AGREEMENT ("AGREEMENT") AFFECTS YOUR LEGAL RIGHTS AND REMEDIES BY PROVIDING THAT DISPUTES BETWEEN YOU AND THE MANUFACTURER, DISTRIBUTOR AND/OR SELLER OF THIS PRODUCT (COLLECTIVELY, "COMPANY"), MUST BE RESOLVED THROUGH BINDING ARBITRATION AND NOT IN COURT. IT ALSO PROVIDES THAT ANY DISPUTE CANNOT BE RESOLVED IN A CLASS ACTION OR OTHER PROCEEDING WHERE YOU REPRESENT OTHER PERSONS OR OTHER PERSONS REPRESENT YOU, AND THAT NO CLASS OR REPRESENTATIVE ARBITRATIONS ARE PERMITTED. PLEASE CAREFULLY READ ALL TERMS IN THIS AGREEMENT.

- 1. RESOLUTION OF CLAIMS OR DISPUTES.** Any claim or dispute between you and Company (or any of Company's subsidiaries or affiliates) arising out of or relating in any way to the Product or this Agreement shall be resolved through final, binding arbitration. This arbitration obligation is reciprocally binding on both you and the Company and applies regardless of whether the claim or dispute involves a tort, fraud, misrepresentation, product liability, negligence, violation of a statute, or any other legal theory. Both you and Company specifically acknowledge and agree that you waive your right to bring a lawsuit based on such claims or disputes and to have such lawsuit resolved by a judge or jury.
- 2. LIMITATION OF LEGAL REMEDIES.** All arbitrations under this Agreement shall be conducted on an individual (and not a class-wide) basis, and an arbitrator shall have no authority to award class-wide relief. You acknowledge and agree that this Agreement specifically prohibits you and the Company from commencing arbitration proceedings as a representative of others or joining in any arbitration proceedings brought by any other person. The parties agree that no class or representative actions of any type are permitted.
- 3. ARBITRATION PROCEDURES.**
 - a. Before instituting an arbitration, if you have any dispute, we strongly encourage you to contact the Company to try to resolve the matter by calling 800-218-3560, although you are not required to do so.
 - b. The arbitration of any claim or dispute under this Agreement shall be conducted in accordance with the expedited procedures set forth in the JAMS Comprehensive Arbitration Rules and Procedures as those Rules exist on the date you receive the Product, including Rules 16.1 and 16.2 of those Rules. These rules and procedures are available by calling JAMS or by visiting its web site at www.jamsadr.com. The arbitration of any claim or dispute under this Agreement shall be conducted by an arbitrator who has at least five years of experience conducting arbitrations.
 - c. The arbitration of any claim or dispute under this Agreement shall be conducted in the State of California or the location in which you received this Agreement. For claims of \$10,000 or less, you may choose whether the arbitration proceeds in person, by telephone, or based only on submissions.
 - d. The Company shall pay costs for the arbitration of claims, including any JAMS Case Management Fee and all professional fees for the arbitrator's services. The Company shall pay the fees and costs of its own counsel, experts and witnesses and shall not be able to recoup them from you even if you do not prevail in the arbitration. Unless otherwise provided by law, you acknowledge and agree that you shall pay the fees and costs of your own counsel, experts and witnesses.
- 4. CHOICE OF LAW.** The arbitration provisions of this Agreement and any arbitration conducted pursuant to the terms of this Agreement shall be governed by the Federal Arbitration Act (9 U.S.C. Secs. 1-16). In this respect, the parties acknowledge that this Agreement involves a transaction conducted in interstate commerce. Otherwise, this Agreement and the rights of the parties hereunder shall be governed by and construed in accordance with the laws of the State of California, exclusive of conflict or choice of law rules.
- 5. SEVERABILITY.** If any provision of this Agreement is declared or found to be unlawful, unenforceable or void, such provision will be ineffective only to the extent that it is found unlawful, unenforceable or void, and the remainder of the provision and all other provisions shall remain fully enforceable.

